

CondoCell®

Always evolving,
Always delivering



 Baker





CondoCell® provides luxury accommodation for cells

CONDOCELL®

- ATMOSPHERE CIRCULATION UNIT (ACU)
- RAPID PURGE UNIT (RPU)

A complete solution for physiological cell culture when used in conjunction with Baker's InvivoO₂ workstation.

PHYSIOLOGICAL

CondoCell® maintains key environmental conditions your cells require for survival when threatened by ambient conditions from outside of the culture environment (e.g. incubator door openings).

PROTECTION

Mitigate the risk of cross contamination between cultures and from room air particulates.

PORTABLE

Allows for limited transport to/ from an incubator or workstation while maintaining the culture environment.

Protect your cells with CondoCell®

Contaminant-free and controlled, air-tight culture vessel.

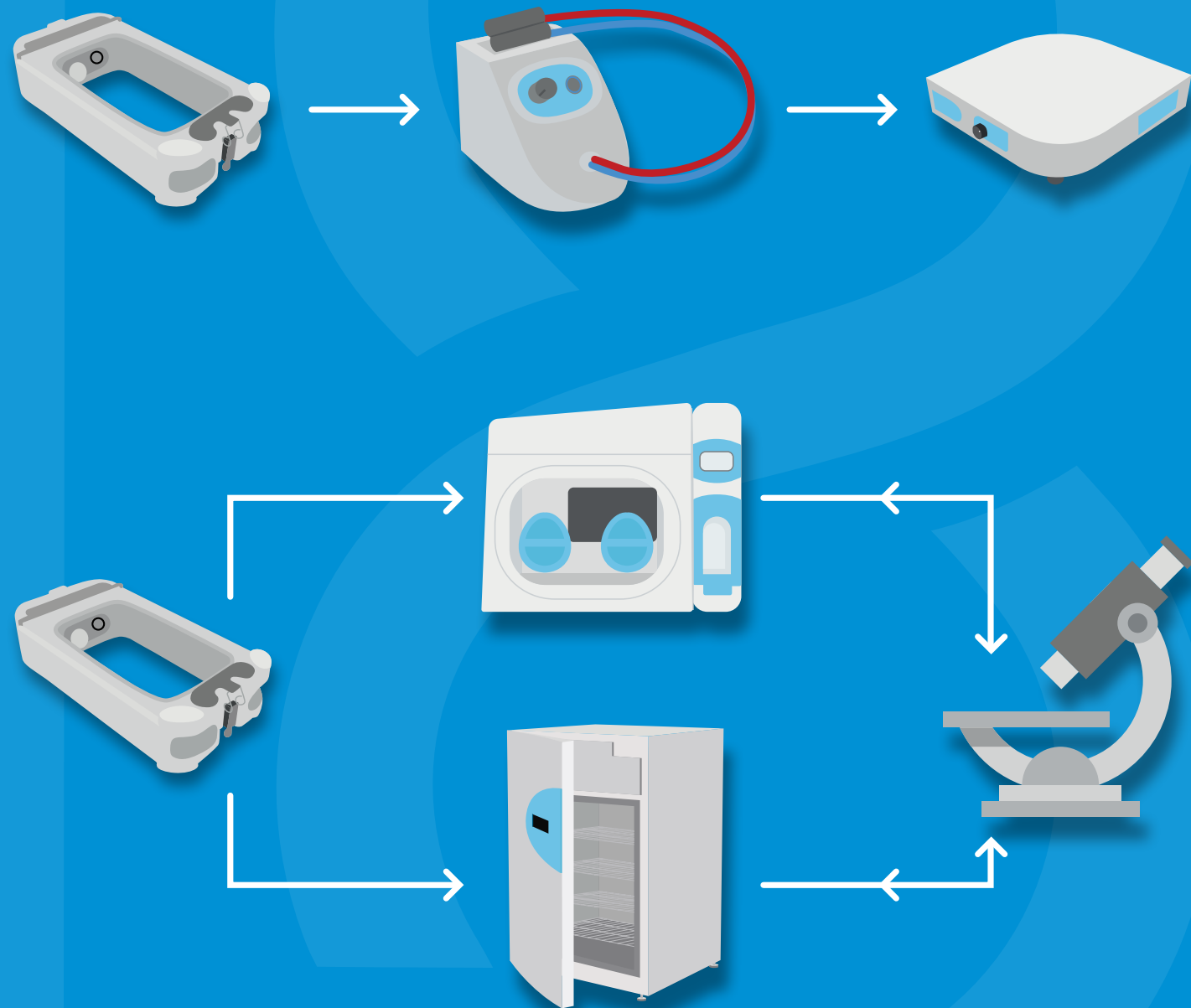

KEY FEATURES



- Clear lid and base allows up to 20X microscopy without disrupting the culture environment
- Increased productivity – researchers can now co-work within a single workstation
- Ideal for continuous physoxia / hypoxia studies
- Increases long term storage capacity when coupled with a workstation and incubator
- Designed to fit within ANY incubator or workstation
- Easy to clean and sterilize
- Filtered, protected and contained environment

The CondoCell® System

Each of our unique solutions may be utilized separately or in conjunction with one another to improve results, based on the needs of your research.



CondoCell®

Contaminant-free and controlled, air-tight culture vessel



Atmosphere Circulation Unit (ACU)

Breathes and distributes the culture environment to the Condos



Rapid Purge Unit (RPU)

Reduces oxygen concentration in a Condo

Retention Time	
Temperature (within 2°C)	20 min
Humidity (within 2%)	60+ min
CO ₂ (within 0.2%)	30 min
O ₂ (within 0.2%)	30 min

w

Mass	1600g	
T75 Flask	1	
T25 Flask	Up to 6	
90mm Cell Culture Dish	Up to 3	
96 Well Plate*	Up to 3	
12 Well Plate*	Up to 2	
External Dimensions		
Width	150mm	5.9in
Depth	278mm	10.9in
Height	65mm	2.6in
Internal Dimensions		
Width	105mm	4.1in
Depth	180mm	7.1in
Height	53mm	2.1in

*Based on typical culturing vessels

Mass	1100g	
Mains Power	8W	
Mains Supply	100-240 V _{AC} 50/60Hz	
Door Timer Delay	0-60 minutes	
Incubator Door Sensors	Up to 4	
Flow Rate	20 mL/minute	
Volume Exchange Rate	1 exchange per hour	
External Dimensions		
Width	150mm	5.9in
Depth	278mm	10.9in
Height	65mm	2.6in

Mass	600g	
Mains Power	3W	
Mains Supply	100-240 V _{AC} 50/60Hz	
Reduce to 1% O ₂ in less than 1 minute		
External Dimensions		
Width	150mm	5.9in
Depth	278mm	10.9in
Height	65mm	2.6in

The maximum number of Condos which can be driven by each ACU is 6.



Scan the QR code to see more about CondoCell®





 Baker



bakerco.com

